

IRONING MACHINE

Instruction Manual

Foreword

The Instruction Manual is necessary for your correct operation of the machine. Be sure to read carefully the instruction manual and fully understand its contents before you start to use the machine. Please carefully keep this instruction manual for future necessary reference.

Requirements and Precautions

1. Proper operation and regular maintenance of the iron are indispensable in order to use it safely in a long time. Before starting any maintenance, please read the general precautions in this manual carefully and fully understand the contents. In addition, please consult our company in case the machine is to be used for other purpose.
2. Please attach this Instruction Manual to the machine in case of resale or tenancy of the machine. In addition, the Instruction Manual will be available upon your application to our company in case your Instruction Manual is lost.
3. In the Instruction Manual, "Warning" symbol appears next to a point that may cause fatal accident or conflagration if users do not observe; "Caution" symbol appears to a point that may cause mechanical damage or malfunction, or personal injury if users do not observe.
4. Our company will not take any responsibility for any application of operation methods which are not included in the Instruction Manual, or for the cases of nonobservance of the indications of "Warning" or "Caution".

Contents

Item	Page
1. Technical parameters	1
2. Accessories	1
3. Dismantled view of machine parts	2
4. Points for Particular Attention before Using	3
5. Method of application	4
5.1. Placement of Machine	4
5.2. Drainage	4
5.3. Water Adding	4
5.4. Power supply connection	4
5.5. Operating panel	5
5.6. Procedures for ending of use	5
6. Maintenance and Overhaul	6
7. Trouble shooting	6
8. Matters need attention	6
9. Machinery wiring diagram	7

1. Technical parameters

Model Number	DL-2
Maximum working pressure(Mpa)	3
Voltage rating	AC 220V
Power	4.4KW (including iron)
Rated current	18A
Vapor volume	7.5 (kg/h)
Size of host machine	40×31×95CM
Weight of complete machine	35 kg

2. Accessories

- ①、2 set of supporting frame for vapor throat of iron
- ②、1 Instruction Manual

Disassembled View

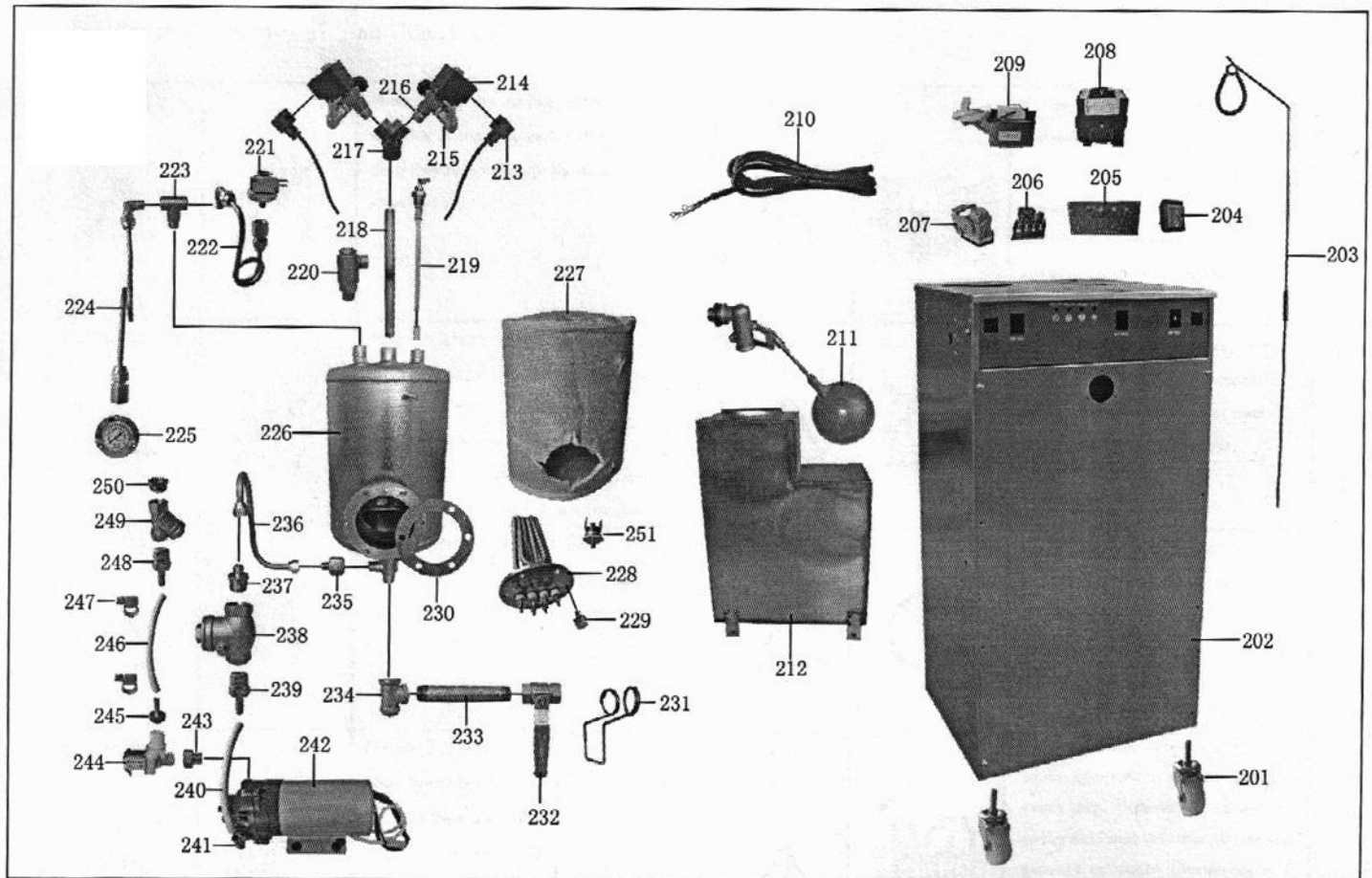

No.	Name	No.	Name	No.	Name
201	Pulley	218	A vapor tube	235	Connector (G1/2)
202	Outer shell module	219	Water level probe	236	Curved tube in copper module
203	Support frame components	220	Safe valve	237	Connector (G1/2)
204	Switch	221	Pressure controller	238	Single direction valve(G1/2)
205	Control plank	222	Curved tube in copper module	239	Connector (G1/2)
206	Rectifier	223	T-shaped three	240	Soft tube in high pressure
207	Four-pin socket	224	Curved tube in copper module	241	L-shaped scimitar
208	Contactor	225	Manometer	242	Water pump
209	Transformer	226	Boiling water containers	243	Connector (G1/2)
210	Power cable	227	Heat preservation cotton set	244	Return to electromagnetism valve
211	Float the ball module	228	Have fever the tube	245	Connector (G1/2)
212	Water tank	229	Screw module	246	Soft tube in high pressure
213	Electromagnetism valve plug	230	Seal completely turn	247	Fastening ring
214	Adjustable electromagnetism valve	231	The safety buttons up	248	Connector (G1/2)
215	The steam nozzle	232	Drain valve	249	Connector (G1/2)
251	Temperature Insurance			250	Fastening ring
				251	Temperature Insurance

4. Particular Precautions before operation

General "Warning" and "Caution"

Warning			Please do not use the iron while the machine casing is opened. Otherwise there may cause electric shock or short-circuit!
Warning			General electric power supply must be cut off before taking down cover plates, or performing maintenance for electric or wiring parts. Otherwise, it may cause electric shock accidents.
Warning			High temperature will be generated near vapor valve and draining valve of case body. It may cause major accident of scald if those parts are touched with naked hands.
Warning			Please adjust pressure to 0MPa when troubleshooting or maintenance is made on tubing parts, then wait for cooling of all tubing parts temperature before any operation. Otherwise it may cause danger of scald.
Warning			Do not sprinkle water on main body of the iron, especially on electric or wiring parts. Otherwise it may cause hazards of electric shock or short-circuit, resulting of malfunction.
Warning			Do not release vapor aiming at people. In addition, do not perform ironing clothes which are pull on by people.
Warning			Do not put near an iron any inflammable matter or oils, or drugs, or do not perform any ironing operation near them.
Caution			Please put the iron on iron-setting table firmly in order to avoid dropping off. In addition, take care not to tilt the main body of the iron set. Otherwise it may damage the iron set or cause personnel injury.
Warning			It may cause major accidents if valves, such as vapor valve, draining valve of case body are opened carelessly. Please properly operate the valves according to the Instruction Manual.
Warning			Do not put volatile matters, such as volatile oil or inflammable matter on top of mechanical body. Otherwise it may cause fire hazard.
Warning			The iron set has already be fully adjusted before delivery. Do not disassemble or rebuild the iron set. Otherwise, false operation, accident or malfunction may be caused.
Caution			Drain off the water inside of vapor generation compartment every day. Otherwise, it may cause malfunctions due to scale deposit or scale incrustation attaches inside of the case body or in the heater, resulting failure of automatic water supply system.
Caution			Unplug power cord immediately when it thunders. Otherwise, it may cause malfunction of power distribution parts.
Caution			Do not drag or pull power cord or other electric wires. Otherwise it may cause short circuit or malfunction.
Warning			Do not go away from an iron with electric power on. Electric power must be cut off when going away from an iron.
Caution			The iron itself has very high temperature. Please do not touch the parts with hands except of iron handle or thermal baffle.

5. Method of application

(1) Put the machine on horizontal ground surface.

(Caution)

If put the machine in a tilting place, water level can not be normally detected. As a result, water feeding and heater can not be controlled, causing operation problem, even malfunction.

(2) Drainage of case body must be done every day. Be sure to have enough space for draining operation.

Draining operation can not be done until vapour pressure is down to 0MPa .

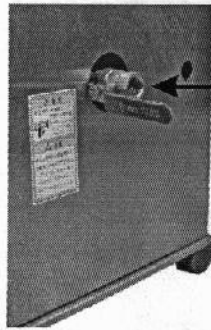

Draw off valve

(Warning)

1. Drainage must be done every day. If not, scale deposit or scale incrustation may be generated inside the case body or heater, which may cause all sorts of malfunctions.
2. When large quantity of vapor is used, water inside of the case body will be concentrated. The ebullient phenomena inside of the case body will be aggravated in a blank burning status. Therefore, please perform drainage over two times a day.
3. The water drained off must not be reused. Direct drain it off because there mixed lots of impurity in the water drained off, which may cause malfunction.

(3) Please put water into the machine.

put water into

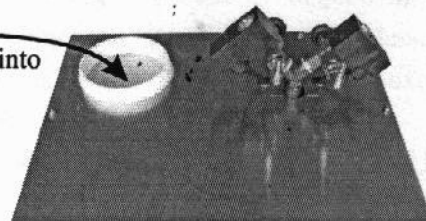

(4) Connection of power supply: 220V, Power supply must be plugged into the receptacle of 40A.

(Warning)

Do not use row sockets as electric receptacles. Otherwise, it may cause fire hazard because row sockets or power cord may become very hot.

• There is a lead at end of the power cord. Prepare a plug matching with specifications of this machine, and connect the plug with breaker of electric leakage.

Please note power supply

Label (orange)

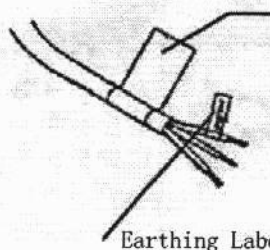

Earthing Label (white)

(Caution)

Regarding power supply of this machine, please refer to the column of Specifications (Page 1). Connect to the power supply according to rated voltage and capacity of this machine. In addition, be sure to connect the ground. The grounding wire must be connected to ground plate.

(Warning) If the ground connection is not performed, you may run a high risk of receiving a serious electric shock.

(5) Operating panel

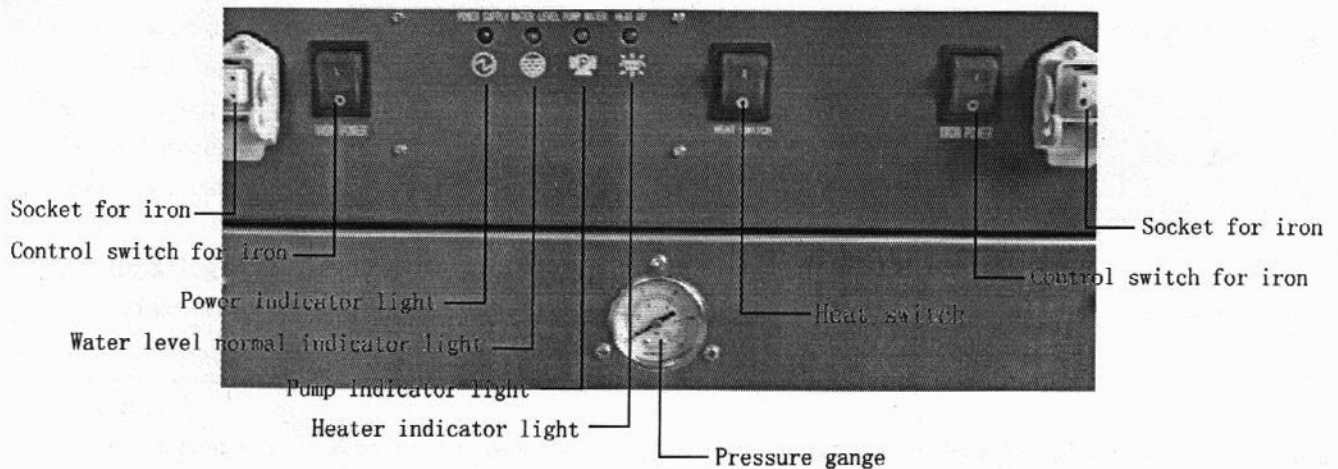

(1) Turn on the Heat switch of operating panel.

(2) After power is turned on, the following procedures will be followed automatically.

- ① Water pump indicator light illuminate. The water pump starts operating and feeding water to the case body for 2-3 minutes, then stops.
- ② Water Level normal indicator light illuminates. Heater is powered on. After 3-5 minutes, vapor pressure is up to 3Mpa, and is in a operationally effective status. Regarding pressure indication, please refer to Names of Exterior Parts of the Machine (Page 2 of this Manual).
- ③ During operation, Water Level Normal Indication Light, Water Pump Indicator Light and Heater Indicator Light will illuminate and go out repeatedly.
- ④ If the water level in the case body is lowered down, the water pump indicator light will illuminate. Water will be fed to the case body automatically.
- ⑤ The machine will automatically alarm if there is not any water in the exterior water tank of the machine. Please add water timely to the water tank.

(Warning)

Please contact with our company if vapor is sprayed out from safety valve inside of the machine. Perform troubleshooting after vapor pressures is lowered to 0MPa.

(Warning)

Cut off the electric power before moving the machine, then gently and slowly move the machine. Otherwise, it may cause sprinkling from the water box.

(6) Procedures at end of operation

Cut off electric power after end of operation. The general power supply must be cut off. Pull out the plug from the receptacle.

6. Maintenance and troubleshooting

(Warning)

Cut off the general power supply and totally discharge off vapor, drain off water when no vapor can be sprayed before perform maintenance or troubleshooting.

6.1 Daily maintenance work and troubleshooting

(1) Daily maintenance

- ① Drainage of case body must be done before daily operation.
- ② Please clean dirt and dust around the main mechanical body of the machine.

(2) Monthly maintenance and troubleshooting

Clean filter of the water feeding inlet inside of the water tank. Water tank may become dirty due to the dust or dirt coming inside, which may cause abnormal water feeding of pump. Clean the water tank by using ironing brush.

6.2 No operation for a long time

- (1) Cut off power supply.
- (2) Drain off water from the case body and water tank.

7 Fault handling methods

Please contact with our company or agent who sells the machine in case any problem happens on this machine.

(Warning)

The general power supply must be cut off and vapor pressure must be lowered to 0MPa when performing troubleshooting

8. Precautions

- ① Any misapplication or poor management may cause major accident. Maintenance work must be done well.
- ② If any abnormal symptom occurs, please cut off general power supply, then find out the reason. In case no cause can be found, please contact our company.
- ③ Cut off the general power supply, or cut off the general breaker, or pull out the plug from receptacle immediately in case the following symptoms occur. Please contact our company. Discharge all vapor and avoid to be scalded when perform troubleshooting yourself.
 - Vapor is sprayed out from safety valve.
 - There is vapor leakage inside of the mechanical parts.
 - There is smoke in the machine.
 - There is water under the machine.
 - There is abnormal sound.
 - There is abnormal offensive odor.
 - Electricity leaking breaker shut down automatically.
 - Water discharged does not come out, or water drainage is not smooth.
 - Other abnormal events occur.
- ④ Perform machine maintenance in order to use it safely in a long time. Timely replace damaged or aged parts. Clear away scale deposit in time. Find out the cause for minor leak and fix it.
- ⑤ Service life period of the machine

The regular service life of the machine is about 7 years under the conditions of suitable maintenance, (soft water is used and 8 hours and 5 days per week).

If operation frequency is higher, (over 8 hours per day and 7 days per week), its service life should be about 5 years.
- ⑥ Cut off the general breaker, or pull out the plug from the receptacle when the machine is not used.
- ⑦ Perform case body drainage of water every day.
- ⑧ If soft water can not be used, blockage may occur due to the scale deposit. Please contact our company in case any abnormal status occurs.

Please pay more attention if the water quality is not good (such as well water).

Wiring Diagram of the Machine

